



YOUR  
GRINDER

# mignon SINGLE DØSE

BEST PRACTICE



*Weigh the desired amount of coffee*

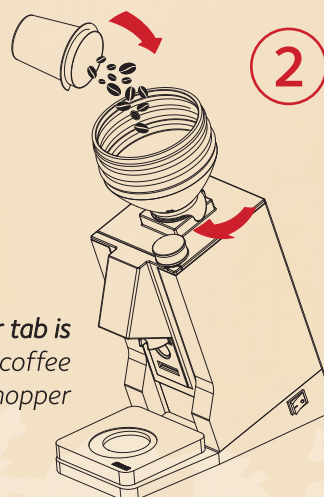

*Check that the **bean hopper tab** is **closed** and then insert the coffee into the bean hopper*

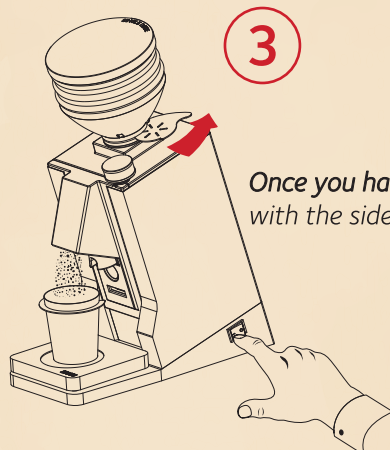

*Once you have started the grinding with the side button, **open the tab***

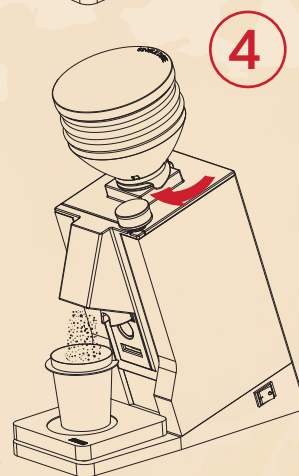

*As soon as the last coffee bean has dropped into the grinding chamber, **close again the tab***

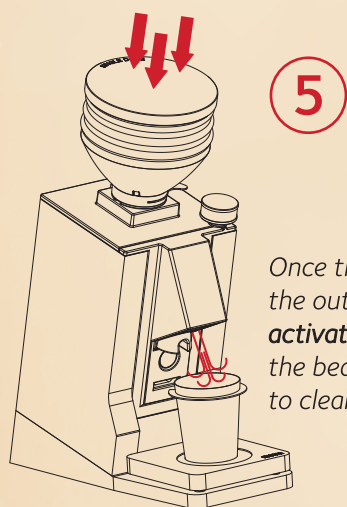

*Once the coffee no longer comes out of the outlet chute, **keep closed the tab** and **activate the Blow Up System** applied on the bean hopper, for the time necessary to clean the grinding chamber*

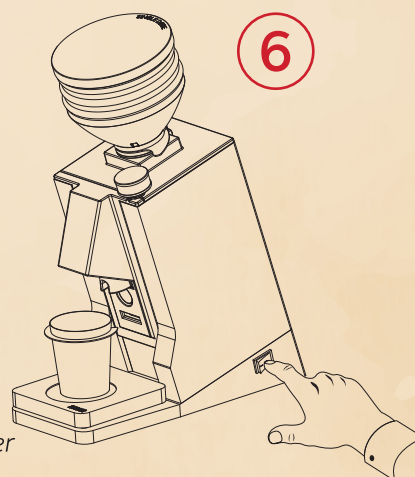

*Turn off the coffee grinder*